

## Caution

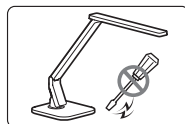

Do not repair, disassemble, or modify under any circumstances.

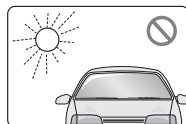

Do not place near any heat sources or in direct sunlight.



Place on flat, secure surface.

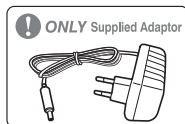

Use ONLY the supplied AC power adaptor.

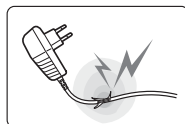

Do not use appliances with frayed or damaged electrical cords.



Do not touch electrical appliances with wet hands or when liquids are present.



Please keep the light and all appliances dry and clean.

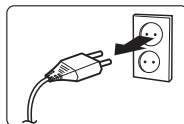

Unplug adapter when the light will not be used for an extended time.



Clean only with a soft dry cloth and do not use solvents or cleaning solutions.

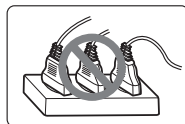

Never overload electrical circuits as it may cause electrical shock or fire.

## Specification

MODEL	DL-90
Color Temp.(K)	Study mode : 6,000~7,000K / Reading mode : 4,300~5,300K Relaxation mode : 2,500~3,300K / Bedtime mode : 2,500~3,300K
CRI	Over 90
Brightness	1,100/1,000/900/750/600Lux ± 100Lux
USB Port	DC 5V --- 700mA(Charging)
LED life-span	Longer than 40,000Hour
Power	AC adaptor : Input AC100V ~ 240V / Output : DC12V --- 2A(or 1.5A)
Power consumption	11W (Lighting), 3W (Charging) Max. 14W
Dimension	180mm(W:Base) x 172mm(D:Base) x 450mm(H) x 352mm(L)
Weight	1,080g
Operating Temperature	-10℃ ~ 40℃

## Warranty Card

Product : LED Desk Lamp

Model : DL-90

Warranty Period : 2year

Purchase Date:

Purchaser	Name	
	Address	
	Telephone	
Seller	Name	
	Address	
	Telephone	

### ► For Repair or Service

If the product stops working correctly, discontinue its use and contact to the service center where you purchased.

### ► Repair Policy

1. This product has passed strict quality control and testing process.
2. Failure of the product under normal operating conditions, during the warranty period may be repaired by Softech LED LLC or our authorized service organization free of charge. Some shipping or handling charges may be involved.
3. For the following cases, some service fees will be charged.
  - 1) When the product is damaged due to user's mishandling, abuse, or improper operation.
  - 2) When the product is damaged due to user's modification, attempted repair, or otherwise access to sealed/non-user serviceable items.
  - 3) When the product is damaged due to fires, pollution, earthquakes and any other natural or unnatural conditions, accidents, etc.
4. It will be at the sole discretion of authorized service center to determine the qualification of the warranty service. Original purchase invoice and other documentation may be required to verify qualification of service.

# LED DESK LAMP

## DL-90/Natural Light Multi-function Lamp

## USER MANUAL

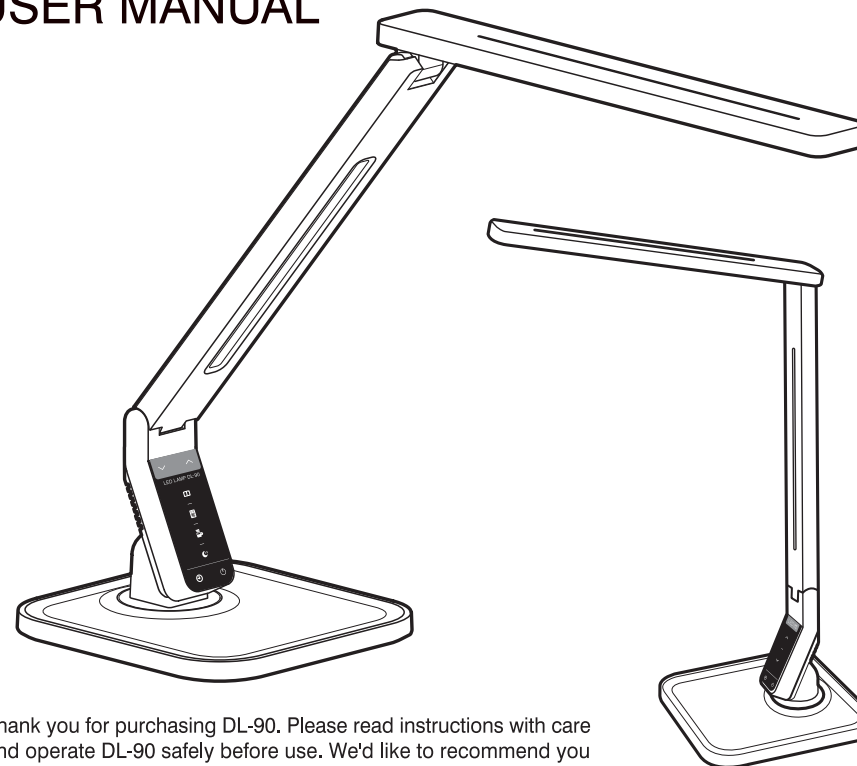

Thank you for purchasing DL-90. Please read instructions with care and operate DL-90 safely before use. We'd like to recommend you to keep instructions to use DL-90 well.

### FCC (Federal Communications Commission)

- **Caution** : Any changes or modifications in construction of this device which are not expressly approved by the party responsible for compliance could void the user's authority to operate the equipment.
- **Note** : This equipment has been tested and found to comply with the limits for a Class B digital device, pursuant to part 15 of the FCC Rules. These limits are designed to provide reasonable protection against harmful interference in a residential installation. This equipment generates, uses and can radiate radio frequency energy and, if not installed and used in accordance with the instructions, may cause harmful interference to radio communications. However, there is no guarantee that interference will not occur in a particular installation. If this equipment does cause harmful interference to radio or television reception, which can be determined by turning the equipment off and on, the user is encouraged to try to correct the interference by one or more of the following measures:
  - Reorient or relocate the receiving antenna.
  - Increase the separation between the equipment and receiver.
  - Connect the equipment into an outlet on a circuit different from that to which the receiver is connected.
  - Consult the dealer or an experienced radio / TV technician for help.

## Advantages of LED Desk Lamp



### Binary Long lifetime

Lasting 40Times Longer than a typical incandescent bulb.  
(Used 5hours per day it will last up to 22years)

### Flicker Free Light

Reduced eye strain without the flickering present in both incandescent and florescent lights.

## Natural Light

LED desk lamp's **CRI** (Color Rendering Index) is **90** over. It reproduces a natural type light source.  
**CRI(Color Rendering Index)**

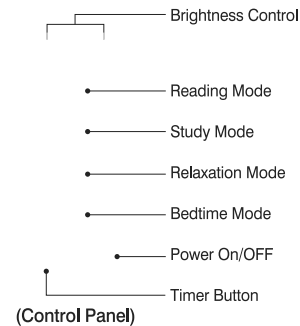

Touch type Control Panel



### Reading Mode (4,300~5,300K Color Temperature)

- Improves language and reading.
- Reduces eye strain when viewing text.
- Favorable for office work.

### Study Mode (6,000~7,000K Color Temperature)

- Stimulates concentration and attention.
- Improved efficiency in mathematics and science.
- Favorable for design and research.

### Relaxation Mode (2,500~3,300K Color Temperature)

- Stimulates sense of security.
- Reduces physical tiredness or stress.
- Favorable for music, art and creative activities.

### Bedtime Mode (2,500~3,300K Color Temperature)

- Stimulates sense of comfort and relaxation.
- Reduces stress with gentle light.
- Favorable for gentile illumination in preparation for sleep.

#### ▶ Timer Control Function.

Automatically turns off the light off in one (1) hour while in any mode of operation.

#### ▶ USB Power Port

Possible to recharge various digital devices such as MP3 & Mobile phone through USB port supplying 5V(700mA) power.

## Brightness at 40Cm

## Easy to Assemble - Instructions

1. Unscrew and remove the attachment nut from the light stand as shown.
2. Assemble the light stand to the light base as shown.
3. Replace the attachment nut to the light stand from where it originally amend hand tighten. (do not over-tighten).

## Multi-Pivot-Flexible Positioning

## Product Box Contains